

| LOT A - R-1XS - Project Info Table |                               |  |                   |
|------------------------------------|-------------------------------|--|-------------------|
| Item                               | R-1XS Requirements            | Proposed                                 |                   |
| Lot Area                           | N/A                           | 414.6sq. m. or 4462.76sq'                | OK                |
| Setbacks:                          | North (Side Exterior): 4.5m   | North: 4.5m                              | OK                |
|                                    | East (Front): 6m              | East: 3.88m to home, 6.2m to garage Door | Variance Required |
| Setbacks:                          | South (Side Interior): 1.5m   | South: 3m to home, 2.09m to stairs       | OK                |
|                                    | West (Rear): 7.5m             | West: 4.87m                              | Variance Required |
| Setbacks:                          | Combined Side: 4.5m           | 6.59m                                    | OK                |
|                                    | Building Height               | Max. 8.0m                                | Max. 8.0m         |
| Lot Frontage                       | Min. 10m                      | 18.6m                                    | OK                |
| Floor Area Ratio                   | Max. 0.6 with secondary suite | Max. 2077sq' = 0.5:1                     | OK                |
| Lot Coverage                       | Max. 40%                      | ~1441sq' = 32%                           | OK                |

| LOT B - R1-S Project Info Table |                                  |                       |                                |
|---------------------------------|----------------------------------|-----------------------|--------------------------------|
| Item                            | R-1S Requirements                | Proposed              |                                |
| Lot Area                        | Min. 480sq. m.                   | 529sq. m. or 5694 sq' | OK                             |
| Setbacks:                       | NORTH (Side Interior): Min. 1.5m | NORTH: 3.64m          | OK                             |
|                                 | EAST (Front): Min. 7.5m          | EAST: 4.88m           | Variance Req'd                 |
| Setbacks:                       | SOUTH (Side Interior): Min. 1.5m | SOUTH: 3m             | OK                             |
|                                 | WEST (Rear): Min. 7.5m           | WEST: 8.1m            | OK                             |
| Setbacks:                       | Combined Side Yards Min. 4.5m    | North + South = 4.5m  | OK                             |
|                                 | Building Height                  | Max. 7.0m             | Approx. 7.19m (to be verified) |
| Lot Frontage                    | Min. 14.75m                      | 23.74m                | OK                             |
| Floor Area Ratio                | Max. 0.4:1                       | 2275sq' = 0.4:1       | OK                             |
| Lot Coverage                    | Max. 30%                         | 1711sq' = 30%         | OK                             |

| LOT C - R-1XS - Project Info Table |                             |  |                   |
|------------------------------------|-----------------------------|--|-------------------|
| Item                               | R-1XS Requirements          | Proposed   |                   |
| Lot Area                           | N/A                         | 293.7sq. m. or 3161sq'   | OK                |
| Setbacks:                          | North (Side Interior): 1.5m | NORTH: 1.5m  | OK                |
|                                    | East (Front): 6m            | EAST: 3.78m to Garage Door, 7.12m to home (2nd parking space here) | Variance required |
| Setbacks:                          | South (Side Exterior): 4.5m | South: 4.5m  | OK                |
|                                    | West (Rear): 7.5m           | West: 4.2m   | Variance Required |
| Setbacks:                          | Combined Side: 4.5m         | 6m   | OK                |
|                                    | Building Height             | Max. 8.0m  | Max. 8m           |
| Lot Frontage                       | Min. 10m                    | 13.14m   | OK                |
| Floor Area Ratio                   | Max. 0.5:1                  | Max. 1560 sq' = 0.5:1  | OK                |
| Lot Coverage                       | Max. 40%                    | ~1125sq' = 36%   | OK                |

| LOT F - R-1XS - Project Info Table |                               |  |                             |
|------------------------------------|-------------------------------|--|-----------------------------|
| Item                               | R-1XS Requirements            | Proposed                               |                             |
| Lot Area                           | N/A                           | 331sq. m. or 3552sq'                   | OK                          |
| Setbacks:                          | North (Side Exterior): 4.5m   | North: 4.5m                            | OK                          |
|                                    | East (Rear): 7.5m             | EAST: 4.13m to 5.71m                   | Variance Required           |
| Setbacks:                          | South (Side Interior): 1.5m   | SOUTH: 3.0m (to home), 2.09m to stairs | OK                          |
|                                    | West (Front): 6.0m            | WEST: 4.45m to porch, 6.4m to home     | Variance Required for North |
| Setbacks:                          | Combined Side: 4.5m           | 6.58m                                  | OK                          |
|                                    | Building Height               | Max. 8.0m                              | Max. 8.0m                   |
| Lot Frontage                       | Min. 10m                      | 15.87m                                 | OK                          |
| Floor Area Ratio                   | Max. 0.6 with secondary suite | max. 2137sq' or 0.6:1                  | OK                          |
| Lot Coverage                       | Max. 40%                      | approx. 1323sq' or 38%                 | OK                          |

| LOT E - R-1 - Project Info Table |                               |   |                |
|----------------------------------|-------------------------------|---|----------------|
| Item                             | R-1 Requirements              | Proposed  |                |
| Lot Area                         | 780sq. m. (8395.8sq')         | 908sq. m. or 9773sq'                            | OK             |
| Setbacks:                        | Left (North) Min. 1.5m        | NORTH: 8.4m                                     | OK             |
|                                  | Rear (East) Min. 7.5m         | EAST: 1.97m                                     | Variance Req'd |
| Setbacks:                        | Right (South) Min. 1.5m       | SOUTH: 11.0m to Keating, 4.87m to Property Line | OK             |
|                                  | Front (Lane) Min. 7.5m        | WEST: 2.54m                                     | Variance Req'd |
| Setbacks:                        | Combined Side Yards Min. 4.5m | North + South = 13.07m                          | OK             |
|                                  | Building Height               | Max. 8.0m                                       | 8.2m           |
| Lot Frontage                     | Min. 21m                      | 23.91m  | OK             |
| Floor Area Ratio                 | Max. 0.45                     | 3107sq' = 0.32:1                                | OK             |
| Lot Coverage                     | Max. 30%                      | 2849sq' = 29%                                   | OK             |

| LOT D - R-1XS - Project Info Table |                             |  |                   |
|------------------------------------|-----------------------------|--|-------------------|
| Item                               | R-1XS Requirements          | Proposed                                   |                   |
| Lot Area                           | N/A                         | 305sq. m. or 3283sq'                       | OK                |
| Setbacks:                          | North (Side Interior): 1.5m | NORTH: 1.5m                                | OK                |
|                                    | East (Rear): 7.5m           | East: 4.20m                                | Variance Required |
| Setbacks:                          | South (Side Exterior): 4.5m | South: 4.5m                                | OK                |
|                                    | West (Front): 6m            | WEST: 3.98m to porch, 6.02m to Garage Door | Variance Required |
| Setbacks:                          | Combined Side: 4.5m         | 6m   | OK                |
|                                    | Building Height             | Max. 8.0m                                  | Max. 8.0m         |
| Lot Frontage                       | Min. 10m                    | 15.68m                                     | OK                |
| Floor Area Ratio                   | Max. 0.5:1                  | Max. 1641sq' or 0.5:1                      | OK                |
| Lot Coverage                       | Max. 40%                    | ~1077sq' = 33%                             | OK                |

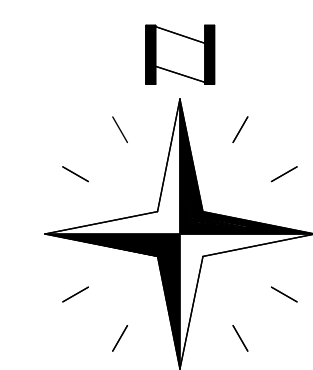
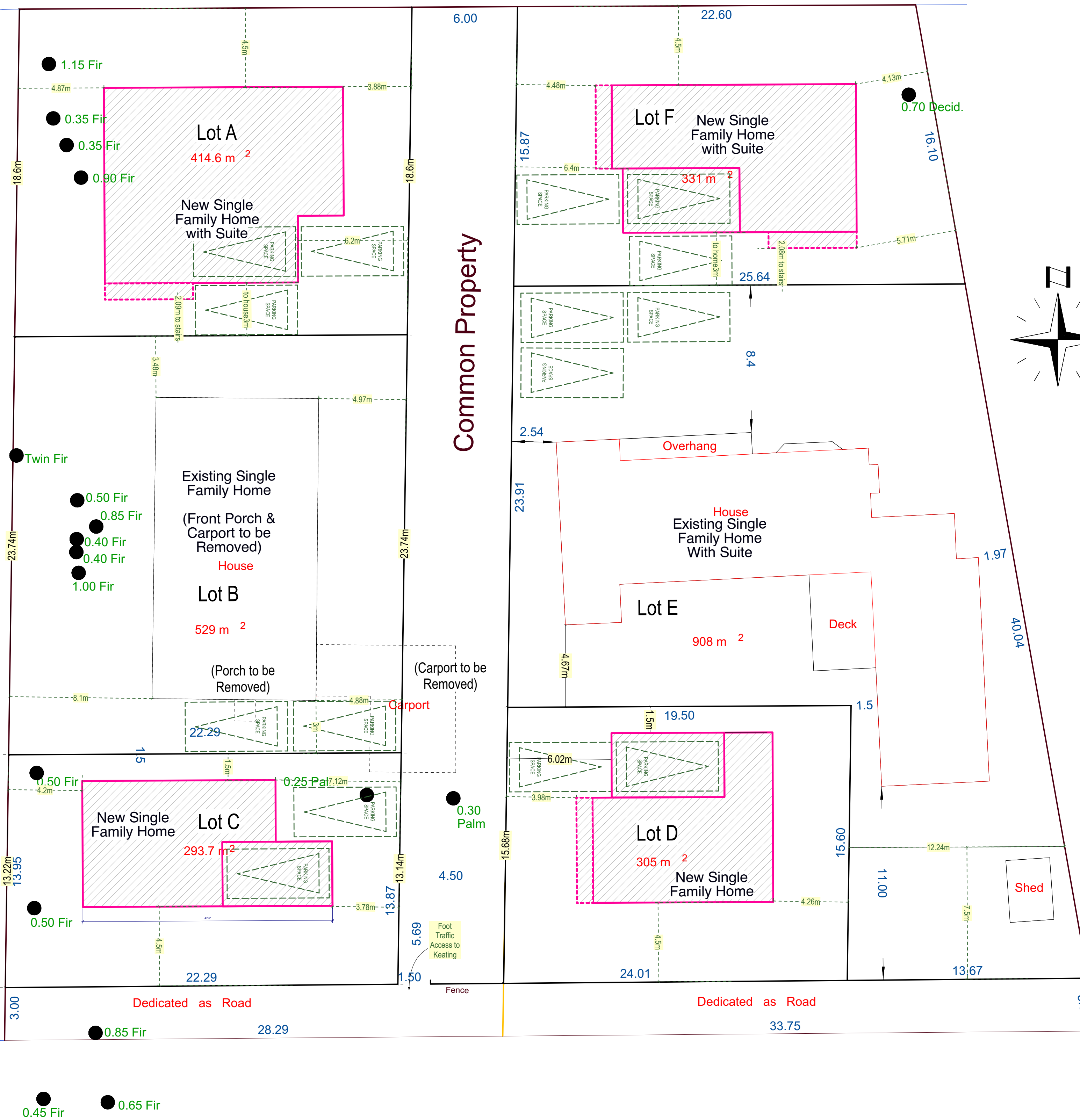

Site Plan  
 Scale: 1:150

|  |                                    |                    |   |
|--|------------------------------------|--------------------|---|
| <p>2302 GROVE CRES.<br/>         SIDNEY, BC<br/>         V8L 3P9<br/>         PH: 250.656.8806<br/>         CELL: 250.889.4918<br/>         cumming.design@shaw.ca</p> | DWG NO:<br><b>1 OF 1</b>           | DESIGN BY:<br>TARA | ~Barbara Drive~<br>Proposed subdivision for:<br>6752 Barbara Drive &<br>2738 Keating X Road |
|  | DATE:<br>2018 Jul 24<br>3:57:04 PM | DRAWN BY:<br>TARA  |   |