

PROPOSED SUBDIVISION OF LOT B, SECTION 8, RANGE 2 EAST, SOUTH SAANICH DISTRICT, PLAN 16626.

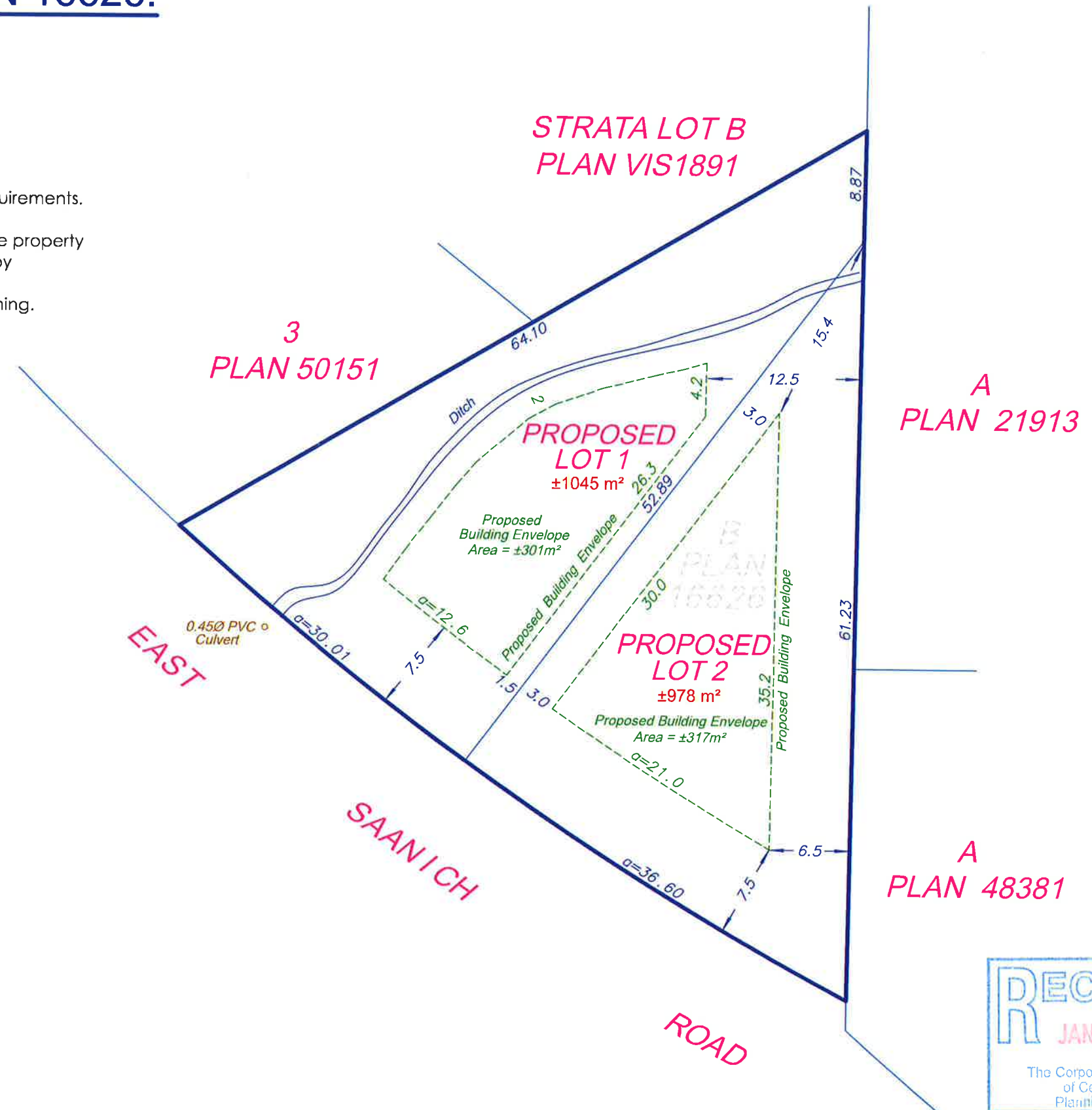

NOTE:
 Lot layout is subject to vary based upon Approving Authority & Engineering requirements.
 Dimensions shown are subject to vary upon legal survey.
 Existing structures, encumbrances, charges, rights of way or covenants upon the property are not shown. This plan is for discussion purposes only and must be approved by approving authorities prior to reliance.
 Proposed development & building envelopes are based upon existing R-1M zoning.

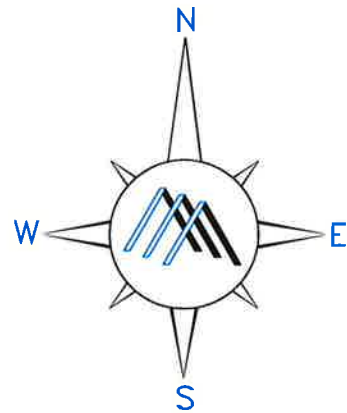

Summit Land Surveying
 Operated by Apex Land Surveying Ltd.
 #101-630 Goldstream Avenue
 Victoria B.C. V9B 2W8
 Telephone 250.391.6708
 www.summitsurveying.ca

File: 81D-DEWIT-SUB7 | Date: December 1, 2020

