

**PROPOSED SUBDIVISION PLAN OF LOT 15,
SECTION 17, RANGE 4 EAST, SOUTH
SAANICH DISTRICT, PLAN 16450.**



NOTE:
Lot dimensions and areas shown are based upon Land Title & Survey Authority records and may vary upon legal survey.
Lot dimensions, offsets, and areas shown may vary upon completion of a comprehensive legal survey. Geodetic elevations shown are based upon observations to geodetic control monument 77H5663 (Elevation= 86.08m)

This plan is for subdivision application purposes only and is for the exclusive use of our client. This plan shall not be used to define property lines or property corners. Unregistered interests have not been included or considered.

LEGEND

- WM Denotes water meter
- W Denotes water valve
- 0.60 Maple Denotes approximate tree location, diameter and species
- Denotes ground elevation
- Denotes utility pole
- Denotes fire hydrant

Field surveys dated October 19th & 22nd, 2018

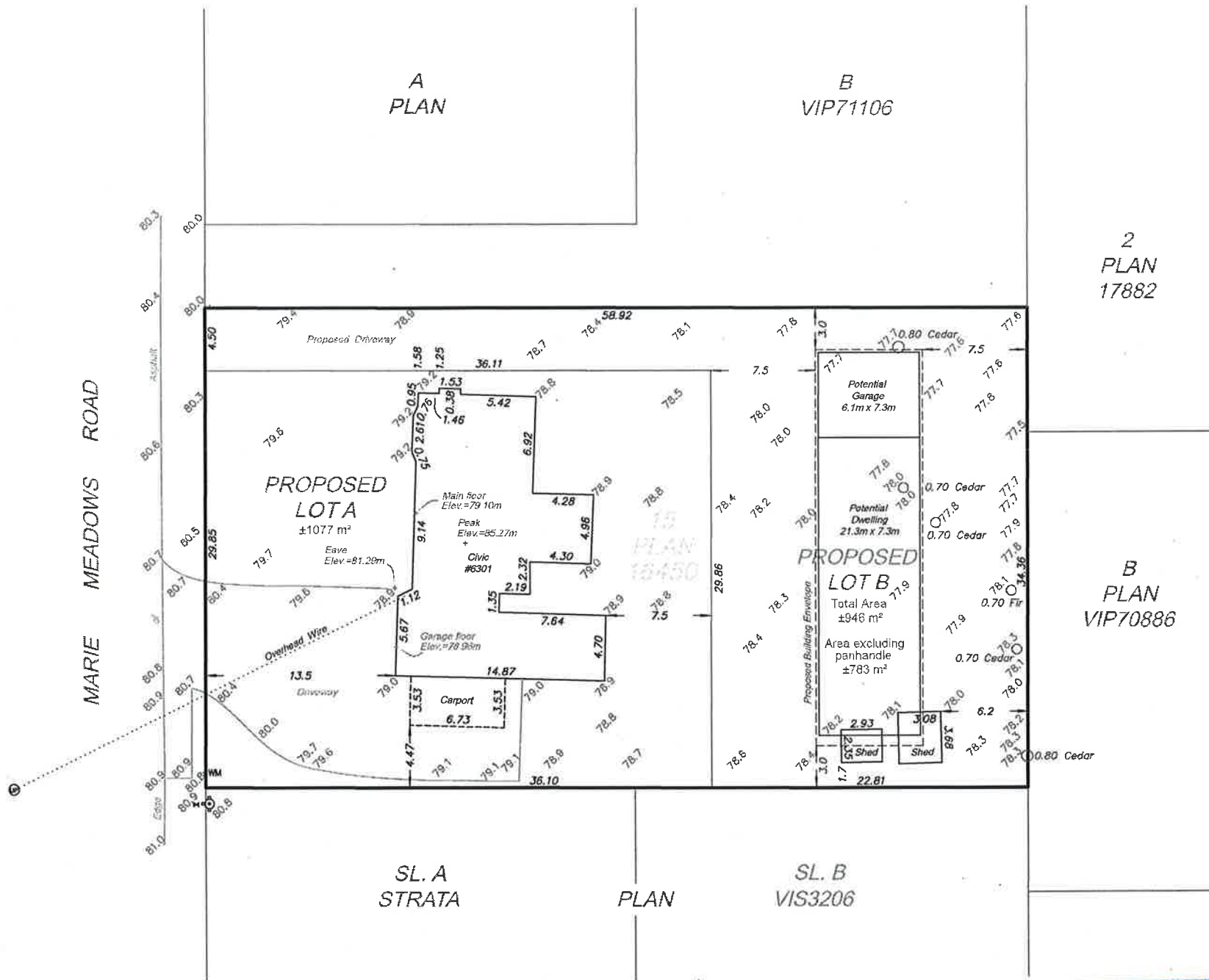
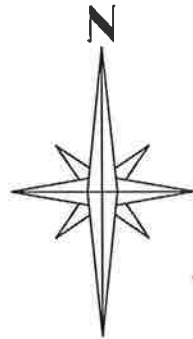

2
PLAN
17882

B
PLAN
VIP70886

File: 75-Lembcke-SD5
Date: February 4, 2019
Island Land Surveying Ltd.
#117-693 Hoffman Avenue
Victoria B.C. V9B 4X1
TEL 250.475.1515 fax 250.475.1516
www.islandsurveying.ca

RECEIVED
MAR - 8 2019
The Corporation of the District
of Central Saanich
Planning Department